

This Island lies about one hundred yards east of the point on the west shore of Nicatous Lake between Moose cove and West Lake Cove.

Nicatous Lake

Nicatous Lake

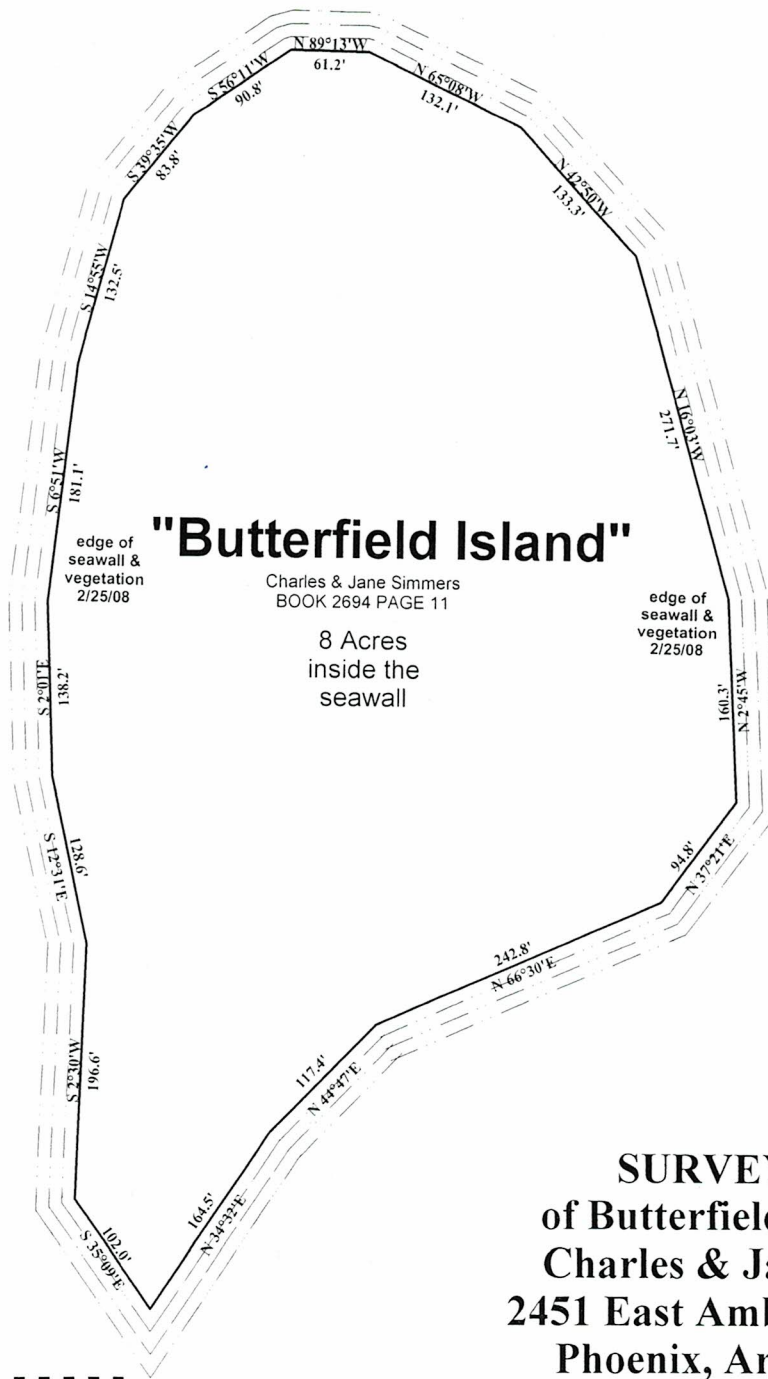

GPS CIS
Grid North-2008



"Butterfield Island"

Charles & Jane Simmers
BOOK 2694 PAGE 11

8 Acres
inside the
seawall

edge of
seawall &
vegetation
2/25/08

edge of
seawall &
vegetation
2/25/08



SURVEY PLAN
of Butterfield's island for
Charles & Jane Simmers
2451 East Amberwood Drive
Phoenix, Arizona 85048
in
Nicatous Lake
in
Twp. 40 MD
Hancock County, Maine

NOTES

This survey meets the Standards of the Board of Licensure for Land Surveyors with the following Exceptions: no written report, no research, no description and no corners monumented.
Deed reference is of this parcel refer to a deed recorded in Book 2694 page 11 of the Hancock County Registry of Deeds.
This surveyed property includes 8 Acres.
This area survey of Butterfield's island was completed with a GIS GPS grade receiver which has an accuracy of three to five meters. This work was done on February 25, 2008 on the ice. Shore points were located on the ice edge of the seawall where the vegetation ended. The shore was ocularly estimated between the points taken on the shore. None of the structures on this island were located. No magnetic bearing taken.

SCALE 1 INCH = 150 FEET



JAMES H. HARRIS, PLS # 1168
BOX 764, LINCOLN, ME. 04457
Dated: February 26, 2008