

BISHOPS_BOTTOM_TRACT

COUNTY:LOWNDES
STATE:MS
ACRES: 181.7

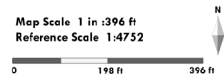

AFM Real Estate
AFMRealEstate.com

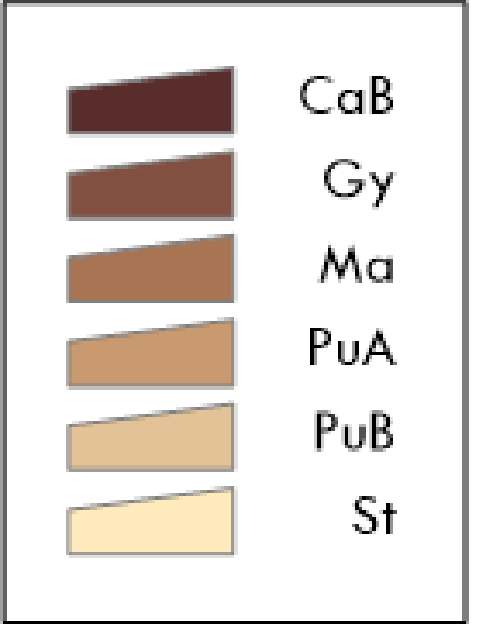
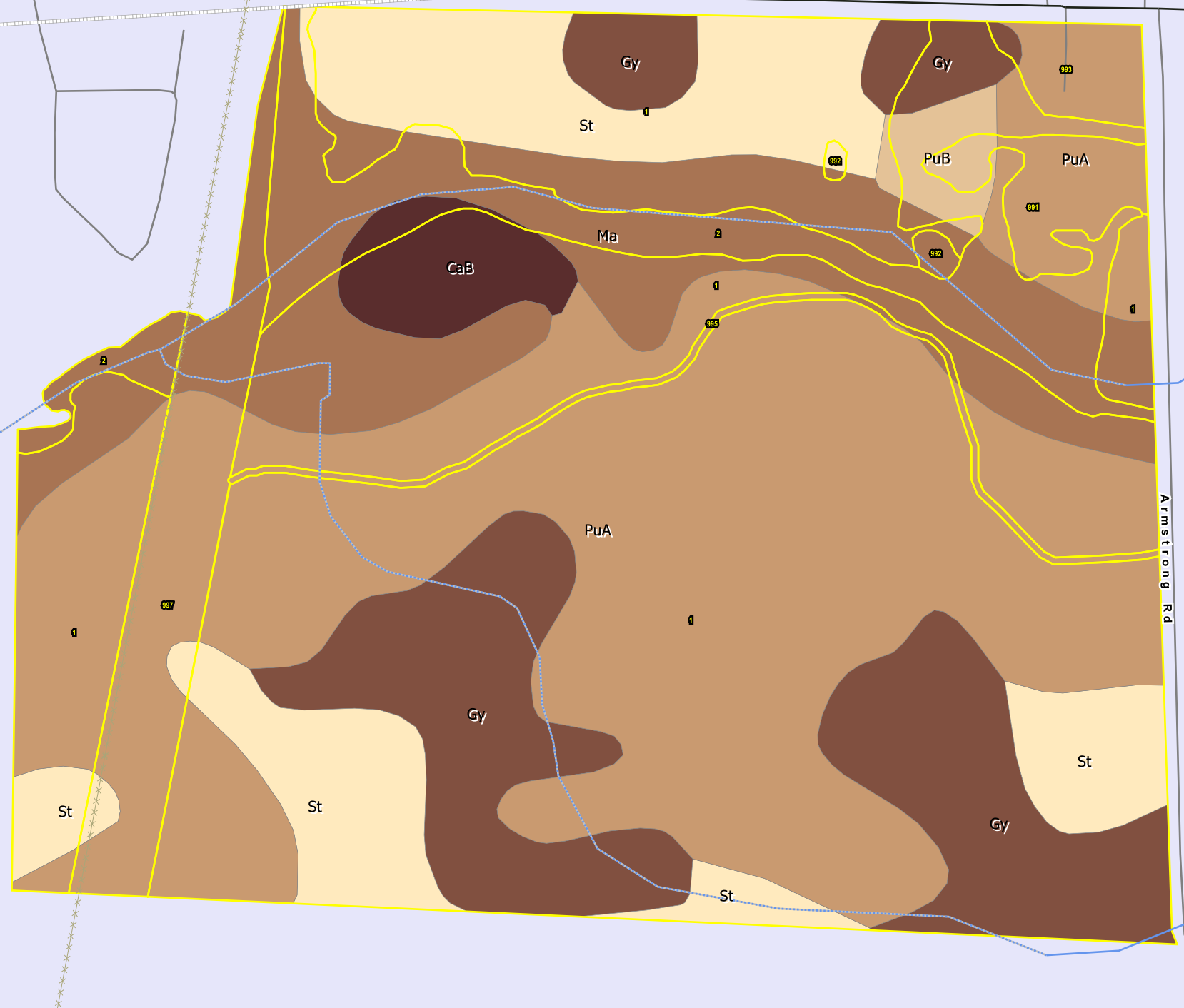
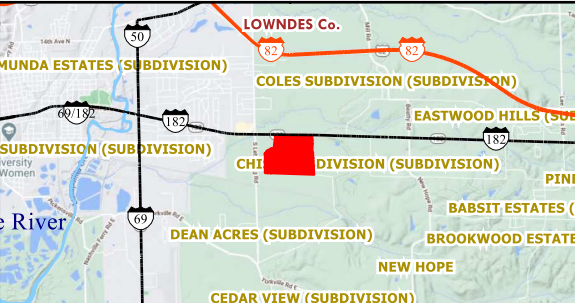

| STAND | DOM_S_NAME | YEAR_EST | DOM_SOIL1 | DOM_SOIL2 | DOM_SOIL3 | ACRES |
|-------|------------|----------|--------------|-------------|-------------|-------|
| 1 | PINE | 2017 | PuA - 71 ac. | Gy - 28 ac. | St - 26 ac. | 146.1 |
| 2 | HARDWOOD | 1960 | Ma - 12 ac. | | | 18.0 |
| 991 | FIELD | 0 | | | | 3.4 |
| 992 | POND | 0 | | | | 0.4 |
| 993 | HOUSE SITE | 0 | | | | 2.4 |
| 995 | ROAD | 0 | | | | 1.5 |
| 997 | ROW | 0 | PuA - 7 ac. | | | 9.9 |

TOTAL ACRES = 181.7

| SOIL SYMBOL | SOIL NAME | FARMLAND | ACRES |
|-------------|---|--|-------|
| CaB | Cahaba fine sandy loam, 2 to 5 percent slopes | All areas are prime farmland | 4.64 |
| Gy | Guyton silt loam, low terrace | Prime farmland if drained and either protected from flooding or not frequently flooded during the gr | 29.51 |
| Ma | Mantachie loam | Prime farmland if drained and either protected from flooding or not frequently flooded during the gr | 32.60 |
| PuA | Prentiss loam, 0 to 2 percent slopes | All areas are prime farmland | 86.54 |
| PuB | Prentiss loam, 2 to 5 percent slopes | All areas are prime farmland | 2.45 |
| St | Steens fine sandy loam | Farmland of statewide importance | 26.48 |



This product is for informational purposes and may not have been prepared for, or suitable for legal, engineering or survey purposes. Users should review or consult the primary data sources to ascertain the usability of the information.